

# Sharpsmart

## ACCESS PLUS | INSTRUCTIONS FOR USE

### TO OPEN

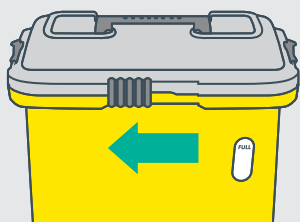

**1** Slide the front lock to the left

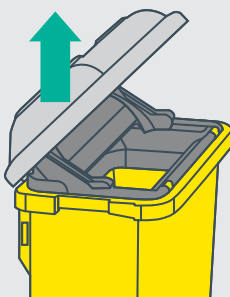

**2** Lift lid to 45 degrees for semi-access opening

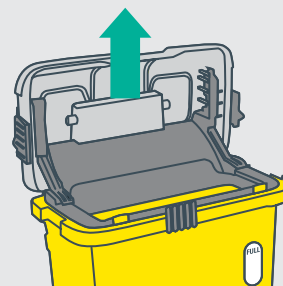

**3** Lift lid to 90° for full access opening

### USAGE

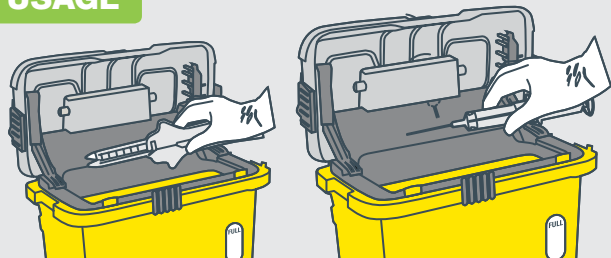

Drop items pointing downwards into opening

### FULL

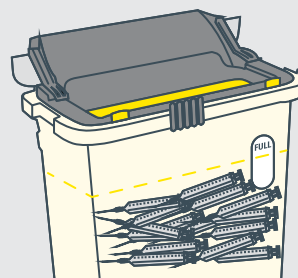

When sharps reach fill level, Access Plus collector is full and must be locked and replaced.

### CLOSE

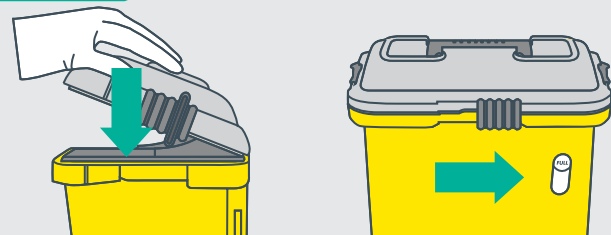

**1** Press lid down firmly.

**2** Slide the front lock fully to the right.

### LOCK

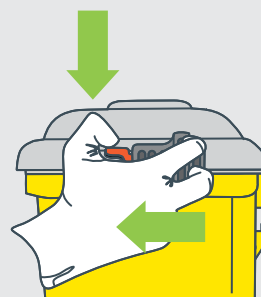

**PLEASE NOTE**  
 Side locks are permanent!

**1** Depress red tabs.

**2** Slide locks completely forward.

#### Remember

Never put your hands into a sharps collector.  
 Always close the collector before moving or removing container.  
 Do not deface or write on the collector.  
 Always dispose of sharps and sharps safety devices into sharps collectors.